



new-build project
'Sonnengarten' daycare centre, Meckenheim

the project

The Ed. Züblin AG is building a daycare centre and a family center with a playgroup on behalf of the municipal building management of Meckenheim.

project data

client:	Ed. Züblin AG / City of Meckenheim
location:	Meckenheim
building type:	daycare centres
services:	new-build project
area:	education and research
scope of services:	HOAI service phases 1-5
completion:	2014
period:	07/2013 - 06/2014
GFA:	1.130 m ²
NFA:	997 m ²



exterior view of the building, entrance



exterior view of the building

our work

Daycare center and family center are designed as a spatial unit and are accessible via separate entrances. A multi-purpose room in between is shared. It ensures the necessary spatial separation of the facilities as well as their functional connection. The pedestrian access is via a common lounge area to Baumschulenallee.

A structured floor plan provides orientation and leaves room for users to design it. Optimized traffic areas enable a central space that is available to the children as an additional play area. Skylights ensure natural lighting. Windows between group rooms and bedrooms make visual contact for supervision.

The building is constructed in a timber frame construction with a slightly sloping, extensively green roof. The semi-permeable outer wall construction consists of wooden frame elements with attached plaster base panels made of wood fiber insulation. The color of the plaster facade is kept in light yellow and white tones. Floor-to-ceiling windows create a connection to the outdoor play area, which - depending on the different usage units - is divided into different functional areas.



exterior view of the building

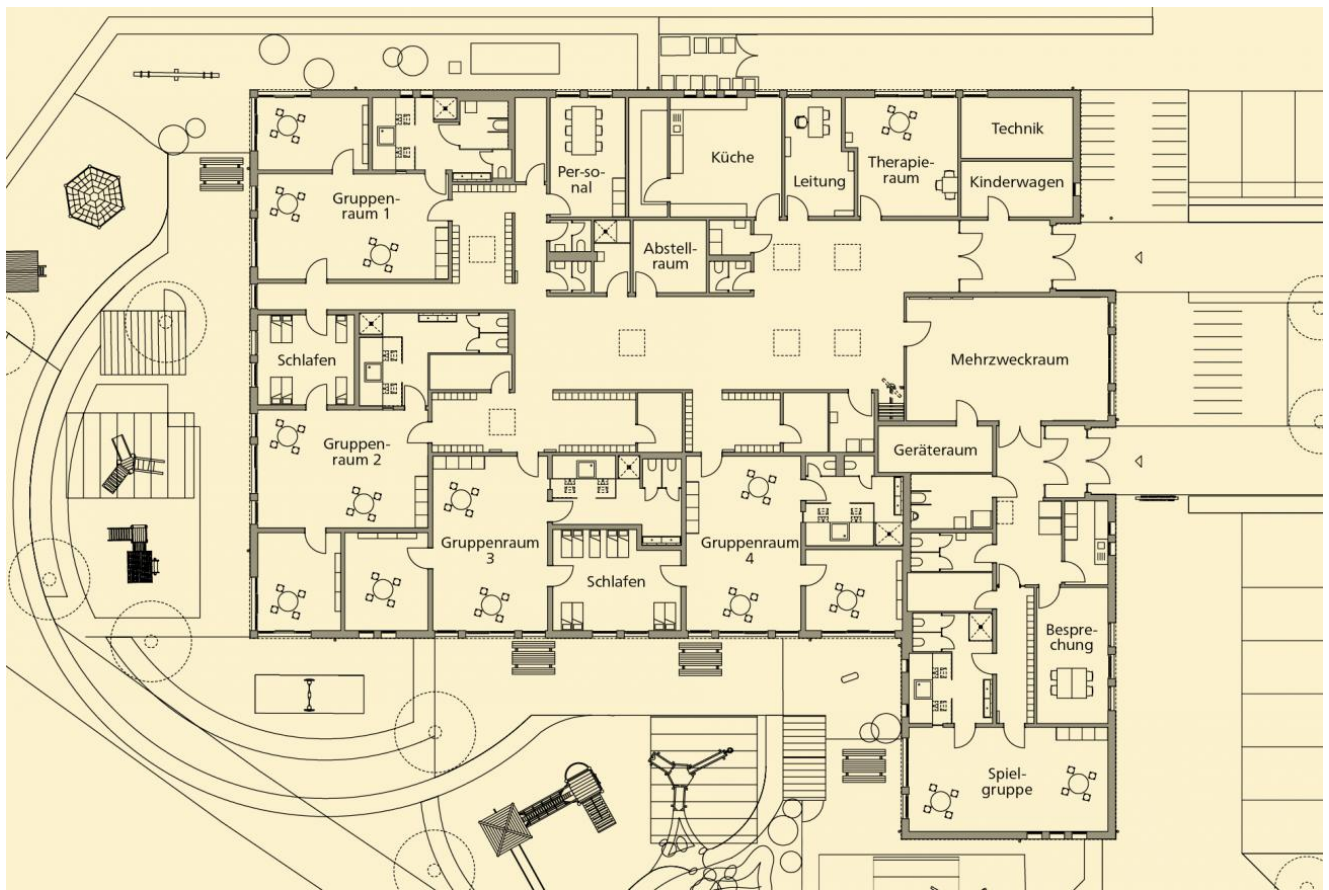



Beyss Architekten GmbH
Haydnstraße 36
53115 Bonn

T +49 228 9 45 54 52-0
F +49 228 9 45 54 52-90

office@beyss-architekten.de